

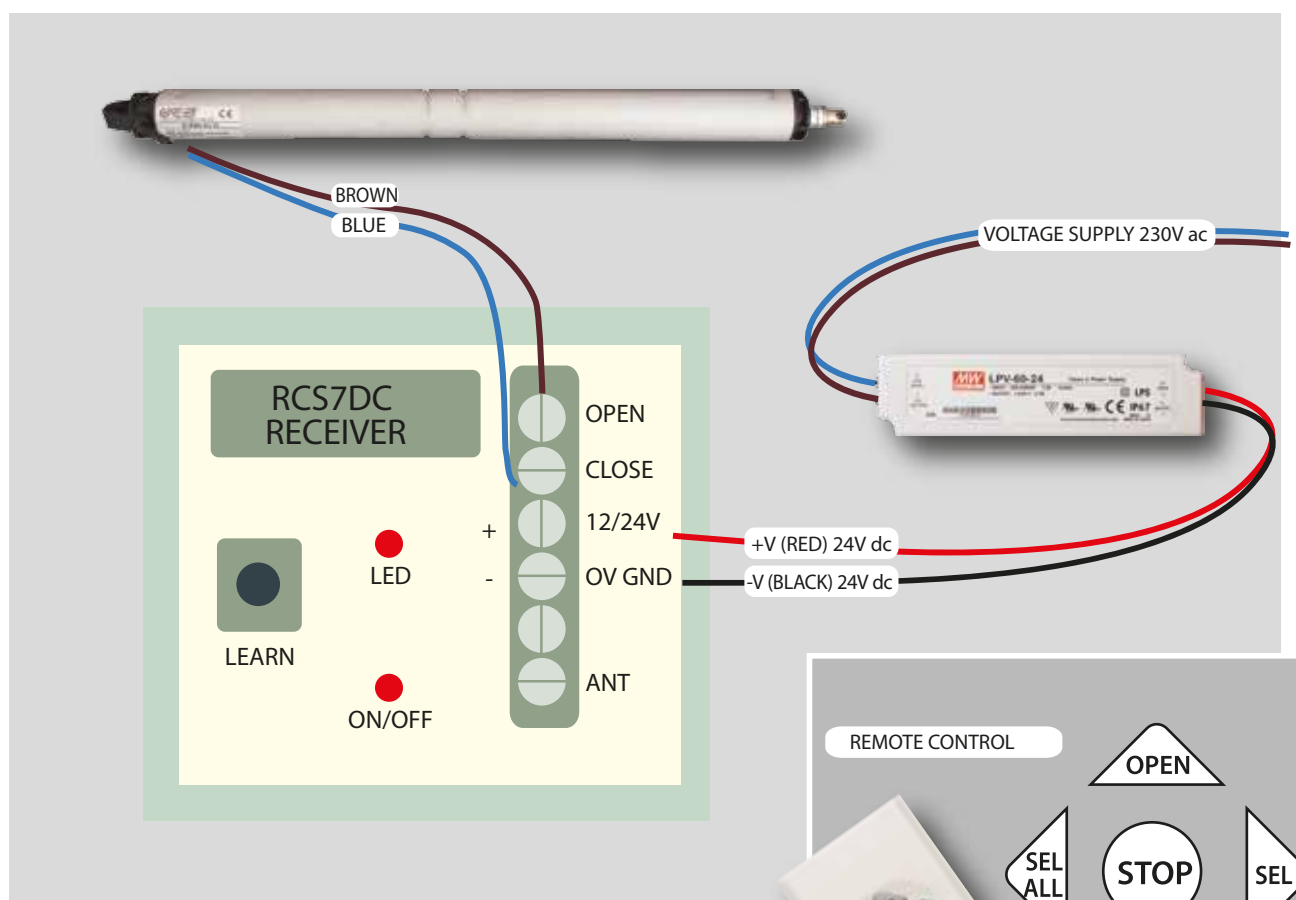

MAMAS STAVROU LTD
Aluminium Pergolas, Sunbreakers & Louvers

ELECTRIC PARTS ASSEMBLY FOR A PERGOLA / SHADE MECHANISM REMOTE CONTROL / RECEIVER PROGRAMMING



SET UP INSTRUCTIONS

- 1 The **RCS7DC** is designed for indoor installations, if used outdoors it should be housed in a suitable weatherproof enclosure.
- 2 Before making any connections ensure that power to the equipment you are connecting to is switched off.
- 3 Connect the **GND** and **12/24V** terminals to a **12 or 24 Volt DC SUPPLY**, if the supply is dc ensure positive is connected to the positive terminal, if unsure use a voltmeter to determine the polarity. The receiver must learn the code of the transmitters before they can be used.
- 4 Switch on the power source supplying the controller and programme the transmitters.
- 5 Press and release the **LEARN** button the red **LED** will light
- 6 Press either of the transmitter buttons, the red **LED** light will flash and then turn off, the transmitter is now programmed and ready to use
- 7 Repeat the above for additional transmitters
- 8 Switch off the power source and make the connections between the **RCS7DC** and the motor to be controlled, switch on the power and check operation
- 9 To erase the receivers memory (delete transmitter codes) press the **LEARN** button for 10 seconds

* **RECEIVERS** and **REMOTE CONTROLS** are already pre-programmed